

36 015 001 EUROPLUS E INFRA-RED ELECTRONIC BASIN MIXER 1/2" WITH MIXING DEVICE AND ADJUSTABLE TEMPERATURE LIMITER

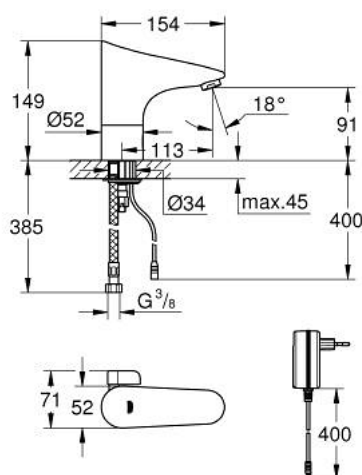

PRODUKTA APRAKSTS

- Krāsa: chrome
- with infrared sensor for bi-directional communication for monitoring, configuration and service purpose
- with plug transformer 100-230 V AC, 50-60 Hz, 6 V DC
- GROHE Long-Life finish
- GROHE Water Saving - Less water, perfect flow
- maximum flow rate (at 3 bar): 5 l/min
- flexible connection hoses
- non-return valve
- dirt strainers
- solenoid valve
- rapid installation system
- 7 pre-set programs:
- auto flush
- thermal disinfection
- cleaning mode
- additional functions and precise settings by remote control 36 407
- CE approved
- acoustic group I in accordance with DIN 4109
- type of protection faucet IP 59K

36 015 001 EUROPLUS E INFRA-RED ELECTRONIC BASIN MIXER 1/2" WITH MIXING DEVICE AND ADJUSTABLE TEMPERATURE LIMITER



REZERVES DAĻAS, jūnijs 2016 – tagad

- 1: Screws (Rezerves daļas Nr. 4283100M)
- 2: Mousseur (Rezerves daļas Nr. 48159000)
- 3: Solenoid valve (Rezerves daļas Nr. 42229000)
- 3.1: Dirt strainer (Rezerves daļas Nr. 42798000)
- 4: Sealing washer (Rezerves daļas Nr. 4283600M)
- 5: Mixer spindle with lever (Rezerves daļas Nr. 42839000)
- 5.1: Mixing lever (Rezerves daļas Nr. 42838000)
- 5.2: Sealing washer (Rezerves daļas Nr. 4284000M)
- 6: Mains adaptor (Rezerves daļas Nr. 42388000)
- 7: Fixing set (Rezerves daļas Nr. 42841000)
- 8: Non-return valve (Rezerves daļas Nr. 4240400M)
- 9: Filter (Rezerves daļas Nr. 4241300M)
- 10: Mounting wrench (Rezerves daļas Nr. 19017000)*
- 11: Switch-mode power supply (Rezerves daļas Nr. 36338000)*
- 12: Mousseur (Rezerves daļas Nr. 36133000)*
- 13: Socket (Rezerves daļas Nr. 36210000)*
- 14: Hidden mixing device (Rezerves daļas Nr. 36209000)*
- 15: Power extension cable (Rezerves daļas Nr. 36340000)*
- 16: Power extension cable (Rezerves daļas Nr. 36341000)*
- 17: Remote control (Rezerves daļas Nr. 36407001)*
- 18: Sticker with pictograph (Rezerves daļas Nr. 4217700M)*

* Izvēles aksesuāri