

31 572 SD0 K500 STAINLESS STEEL SINK WITH DRAINER

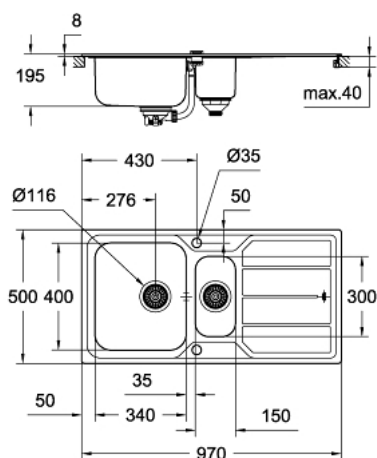

PRODUKTA APRAKSTS

- Krāsa: stainless steel
- model: K500 60-S 97/50 1.5 rev
- mounting type: standard built-in
- material: stainless steel AISI 304 (V2A)
- material thickness: 0.7 mm
- GROHE Long-Life finish
- finish: satin finish
- GROHE Whisper
- min. cabinet size: 600 mm
- dimensions: 970 x 500 mm
- 1 bowl: 340 x 400 x 195 mm
- 0.5 bowl: 150 x 300 x 150 mm
- GROHE FastFixation installation system
- sink mountable left or right
- cut-out: 950 x 480 mm
- drilling holes: 2 x 35 mm
- drainer: automatic waste fitting
- accessories included: waste kit, basket strainer waste, mounting set
- amount of fasteners included (top mount): 8
- outer radius: R10, inner bowl radius: R60

31 572 SD0 **K500 STAINLESS STEEL SINK WITH DRAINER**

REZERVES DAĻAS, septembris 2017 – tagad

1: Plug (Rezerves daļas Nr. 42576SD0)

2: Turning handle (Rezerves daļas Nr. 42575SD0)

3: Plug (Rezerves daļas Nr. 42580SD0)

