

26 507 DA0 EUPHORIA SMARTCONTROL SYSTEM 310 DUO SHOWER SYSTEM WITH THERMOSTAT FOR WALL MOUNTING

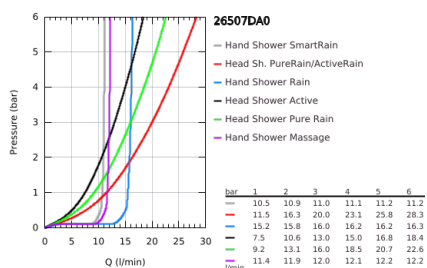
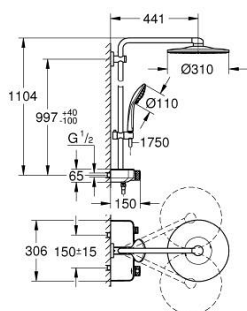

PRODUKTA APRAKSTS

- Krāsa: warm sunset
- consisting of:
 - horizontal 450 mm shower arm
 - upper bracket adjustable for minimal adaption to existing drilling holes
 - exposed SmartControl thermostat
- allows change between:
 - head shower Rainshower SmartActive 310
- 2 spray patterns:
 - GROHE PureRain, ActiveRain
- maximum flow rate (at 3 bar): 20 l/min
- hand shower Euphoria 110 Massage, spray plate white
- 3 spray patterns:
 - Rain, SmartRain, Massage
- maximum flow rate (at 3 bar): 16 l/min
- adjustable in height with gliding element
- Silverflex shower hose 1750 mm 1/2" x 1/2" (28 388)
- GROHE DreamSpray perfect spray pattern
- GROHE Long-Life finish
- GROHE CoolTouch no risk of scalding
- GROHE TurboStat compact cartridge with wax thermoelement
- GROHE ProGrip with knurl structure
- GROHE SafeStop safety button at 38°C
- GROHE SafeStop Plus optional temperature limiter at 43°C included
- GROHE SmartControl push for ON-OFF, turn for volume adjustment from GROHE Water Saving to Full Flow
- integrated GROHE EasyReach shower tray
- SpeedClean anti-lime system
- Inner WaterGuide for a longer life
- TwistStop to prevent hose from twisting
- suitable for instantaneous heaters from 18 kW/h
- minimum flow rate 7 l/min.

26 507 DA0 EUPHORIA SMARTCONTROL SYSTEM 310 DUO SHOWER SYSTEM WITH THERMOSTAT FOR WALL MOUNTING

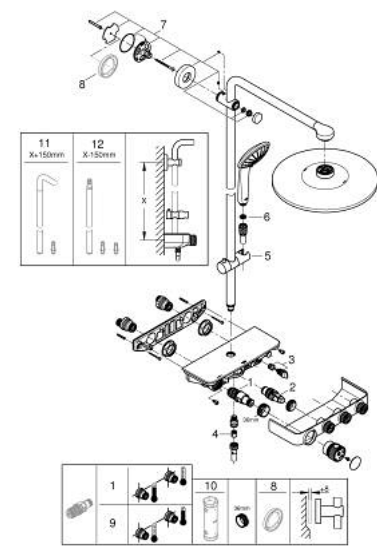

REZERVES DAĻAS, septembris 2018 – novembris 2021

- 1: Thermostatic compact cartridge 1/2" (Rezerves daļas Nr. 47439000)
- 2: Cartridge (Rezerves daļas Nr. 48297000)
- 3: Non-return valve (Rezerves daļas Nr. 49069000)
- 4: Non-return valve (Rezerves daļas Nr. 08565000)
- 5: Glide element (Rezerves daļas Nr. 48177DA0)
- 6: Dirt strainer (Rezerves daļas Nr. 0700200M)
- 7: Shower bar holder (Rezerves daļas Nr. 48279DA0)
- 9: GROHE TurboStat cartridge 1/2" (Rezerves daļas Nr. 47175000)*
- 10: Socket spanner (Rezerves daļas Nr. 49059000)*

* Izvēles aksesuāri