

## 23 231 000 **WAVE COSMOPOLITAN SINGLE-LEVER BASIN MIXER 1/2"** **S-SIZE**

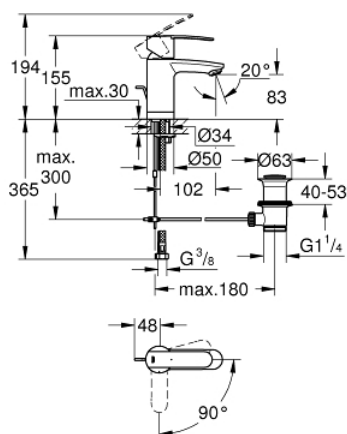

### PRODUKTA APRAKSTS

- Krāsa: chrome
- single hole installation
- metal lever
- GROHE SilkMove Energy Saving 35 mm ceramic cartridge with energy saving function via cold start
- adjustable flow rate limiter
- adjustable minimum flow rate approx. 2.5 l/min
- GROHE Long-Life finish
- mousseur
- pop-up waste set 1 1/4"
- flexible connection hoses
- GROHE FastFixation installation system with centering support
- optional temperature limiter ref. no. 46 375 000
- GROHE QuickTool included

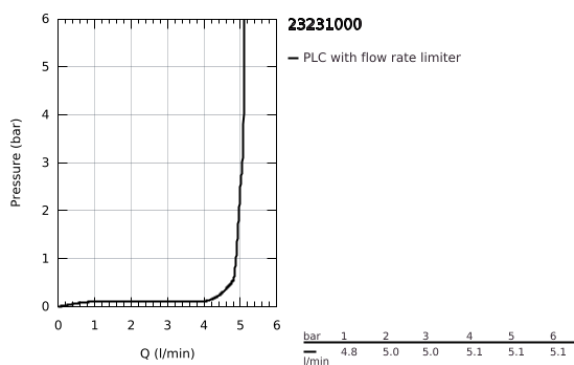

## 23 231 000 **WAVE COSMOPOLITAN SINGLE-LEVER BASIN MIXER 1/2"** **S-SIZE**

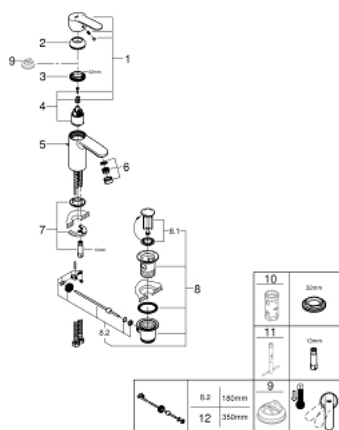

### REZERVES DAĻAS, maijs 2014 – tagad

- 1: Lever (Rezerves daļas Nr. 46829000)
- 2: Cap (Rezerves daļas Nr. 46492000)
- 3: Screw coupling (Rezerves daļas Nr. 46460000)
- 4: Cartridge (Rezerves daļas Nr. 46863000)
- 5: Pop-up rod (Rezerves daļas Nr. 46739000)
- 6: Mousseur (Rezerves daļas Nr. 48159000)
- 7: Shank mounting kit (Rezerves daļas Nr. 46671000)
- 8: Waste set 1 1/4" (Rezerves daļas Nr. 28910000)
- 8.1: Plug (Rezerves daļas Nr. 07182000)
- 8.2: Eccentric rod (Rezerves daļas Nr. 07052000)
- 9: Temperature limiter (Rezerves daļas Nr. 46375000)\*
- 10: Socket spanner (Rezerves daļas Nr. 19332000)\*
- 11: Mounting wrench (Rezerves daļas Nr. 19017000)\*
- 12: Eccentric rod (Rezerves daļas Nr. 07341000)\*

\* Izvēles aksesuāri